

LED FLASHER

WIRING / OPERATION

- **RED:** To +VDC (fuse @ 1A)
- **BLACK:** Ground (Chassis)
- **YELLOW:** For Synchronization and Flash Pattern

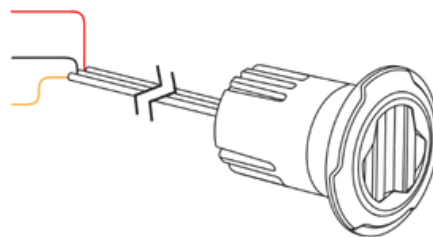

For Simultaneous or Alternating Flash:

1. Apply +VDC to RED and YELLOW wires simultaneously to enter Grouping mode; lighthouse will display short (single or double) flash:
 - Single flash = Group1
 - Double flash = Group2
2. Remove YELLOW wire from +VDC then momentarily apply +VDC to change Groups:
 - Heads of the same Group will flash together.
 - Heads of different Groups will flash alternately.
3. Save and Exit the Grouping Mode by powering off the lighthouse.

For Flash Patterns:

Momentarily apply +VDC to YELLOW wire:

- once for next pattern
- quick three times for FP#1

NOTE: This unit may not be factory set at FP# 1.

FLASH PATTERNS	
1	Double [R65]
2	Single [2Hz]
3	Triple [2Hz]
4	Quad [2Hz]
5	Random
6	Steady
7	Single [SAE] [CA13]
8	Mega [SAE]
9	Double [SAE]
10	Triple [SAE]
11	Quad [SAE]
12	Quint [SAE]
13	Ultra [SAE]
14	Single-Quad
15	Single H/L
16	Singe-Triple-Quint

LED FLASHER

INSTALLATION - FLUSH MOUNT

1. Select a mounting location and drill an 1" (25.4mm) cut-out.

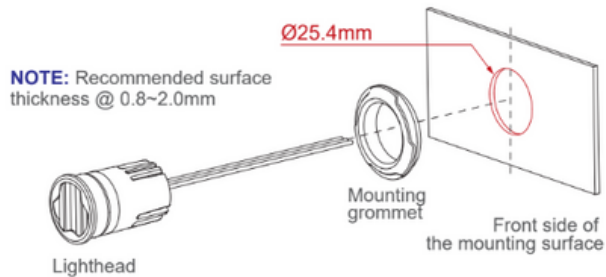

2. From the front, install the MOUNTING GROMMET onto the cut-out, and insert the LIGHTHEAD.

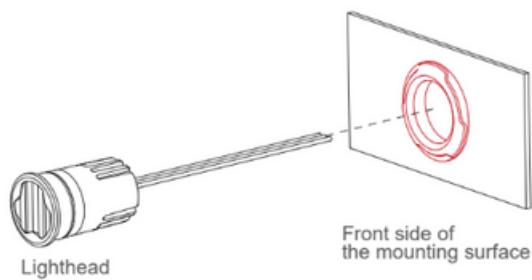

3. Ensure that the optical stripes are aligned vertically.

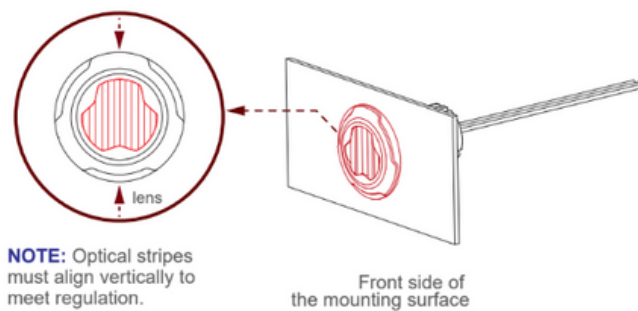

4. Where necessary, apply silicone around the reverse side to prevent from rotating.

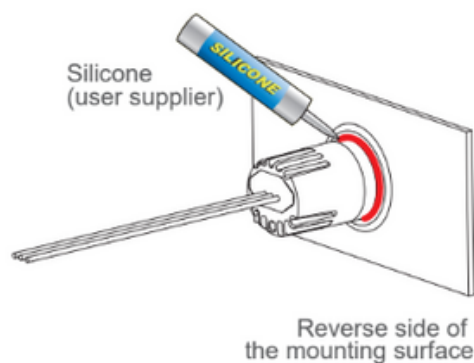

LED FLASHER

INSTALLATION - BRACKET MOUNT (sold-separately)

1. From the front, install the MOUNTING GROMMET onto the BRACKET, and insert the LIGHTHEAD.

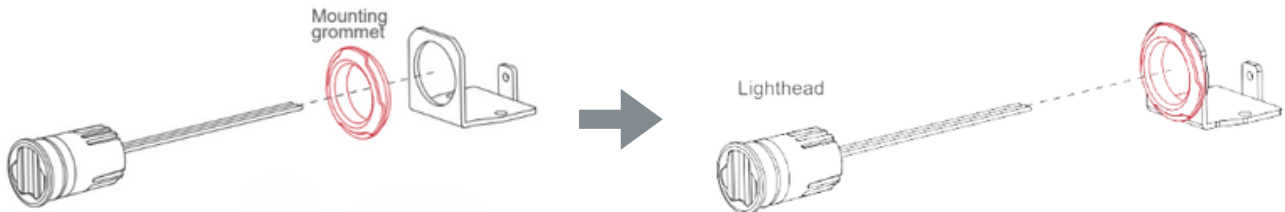

2. Ensure that the optical stripes are aligned vertically.

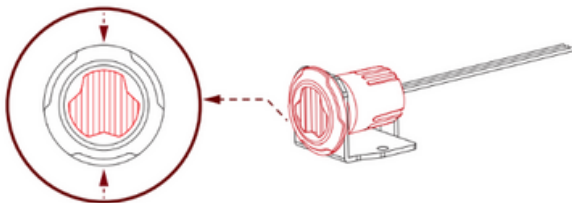

NOTE: Optical stripes must align vertically to meet regulation.

3. Secure the LIGHTHEAD onto the BRACKET with a screw.

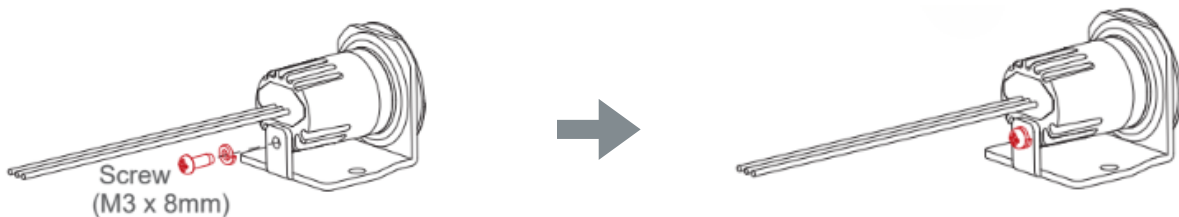

4. Secure the BRACKET onto the desired mounting surface with screws.

